

MC-A series  
**Mass Comparator**  
**Setup Instructions**

MC-1104A / MC-6203A



Scan this QR code for the manual.

- Please refer to the section titled "**Precautions Before Use**" in the instruction manual.
- The balance is a precision instrument. Unpack the balance carefully.
- Please confirm that all accessories are included.
- We recommend keeping the packaging materials for future transportation, such as as when sending the unit for repairs.

Assemble the unit as shown in the diagram.

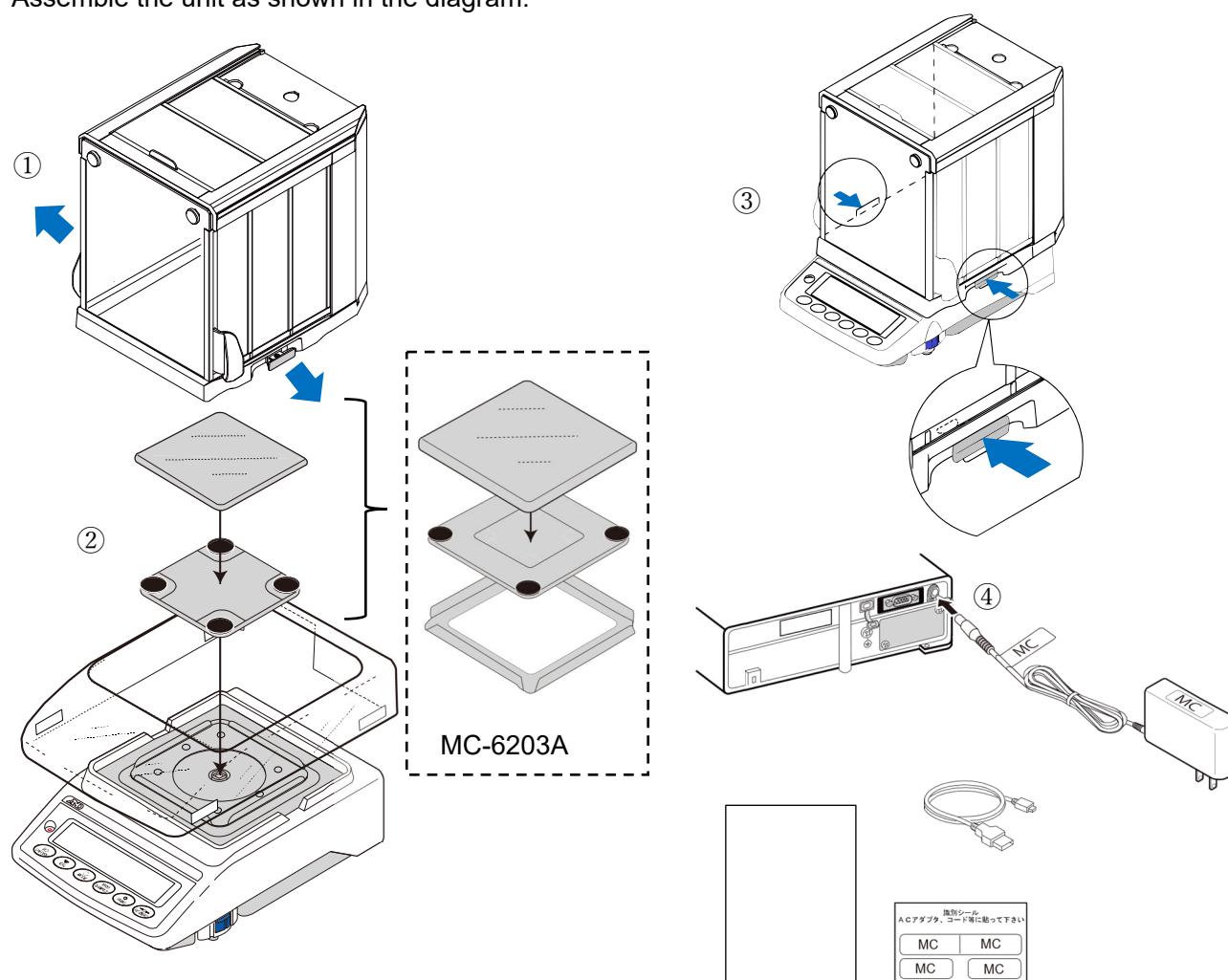

Setup Instructions

**CAUTION**

- Use the designated AC adapter.
- Install in a room with minimal dust.
- Place the balance on a sturdy weighing table.
- Do not place the balance where it is directly exposed to air from air conditioners, etc.
- Do not install the balance in areas with corrosive or flammable gases.
- Before use, keep the AC adapter connected and powered on for at least one hour.
- After installation, perform sensitivity adjustment to ensure accurate weighing.

1WMPD4005765

## How to adjust the level of the balance

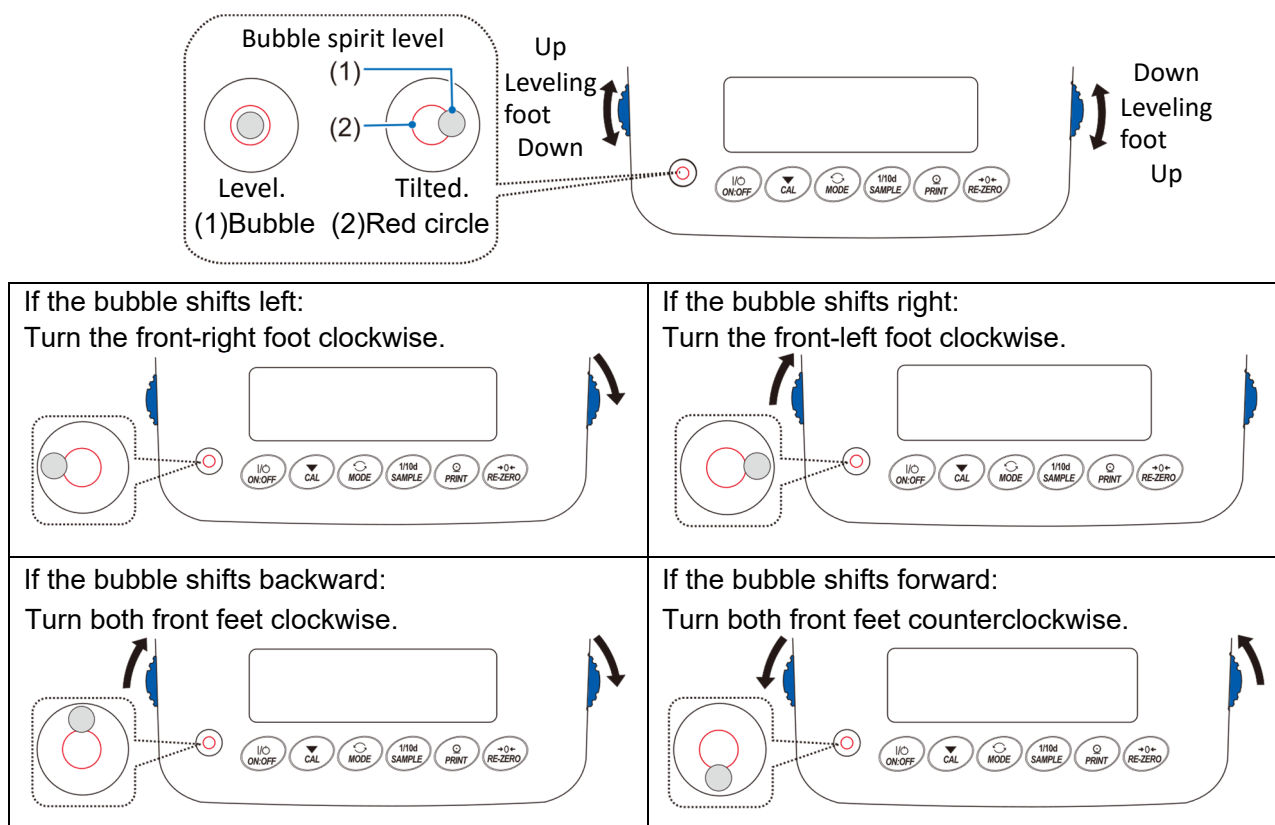

## Specifications

	MC-1104A	MC-6203A
Weighing capacity	1100 g	6200 g
Maximum display	1100.0084 g	6200.084 g
Readability	0.0001 g	0.001 g
Repeatability <sup>*1</sup> (Standard deviation)	0.00035g	0.0035 g (2000 g ~ 5000g) 0.0015 g (2000 g less than)
Linearity <sup>*1</sup>	±0.003 g	±0.03 g
Accuracy after sensitivity adjustment using the internal weight <sup>*2</sup>	±0.010 g	±0.15 g
Weighing pan size	128 × 128 mm	165 × 165 mm
Main body weight	Approx. 7 kg	
External dimensions	259(W) × 358(D) × 332(H) mm (with a large glass breeze break)	
Operating environment	5°C to 40°C (41°F to 104°F), 85%RH or less (No condensation)	
Power (AC adapter)	AC adapter Confirm that the adapter type is correct for the local voltage and power receptacle type. Power consumption: Approx. 30 VA (supplied to the AC adapter)	
Power consumption	DC 12V Approx. 0.2A (excluding AC adapter and options)	

<sup>\*1</sup> When the auto-centering pan is used or when loading and unloading are performed at the same place using the automatic loading machine under good ambient conditions.

<sup>\*2</sup> The operating environment must be free from sudden changes in temperature or humidity, vibration, airflow, magnetic fields, and static electricity.